

MPS-2300 series Pressure Sensor

■ Features

- Competitive price DIP package
- Wide operating temperature range:- 40 to +85°C
- Solid-state reliability
- Easy to use
- Easily embedded in OEM equipment
- Gauge pressure type (5.8 、 15 PSI)

■ Applications

- Digital blood pressure meter
- Digital pressure gauges
- Environmental monitoring
- Consumer & sports
- Medical instrumentation & monitoring
- Disposable blood pressure sensor

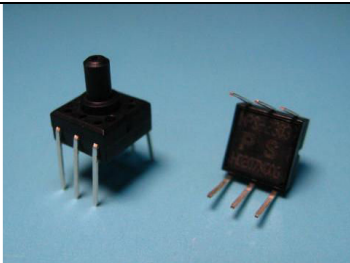
Pressure type	Gauge
	MPS-2300 series
Model	

■ Outline dimensions

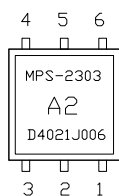
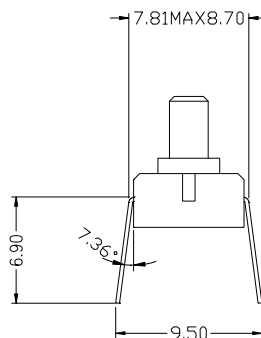
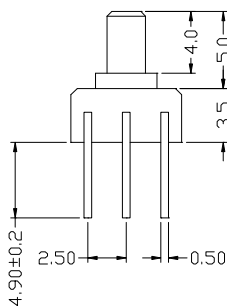
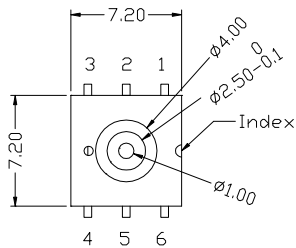

Unit:mm
General tolerance:±0.1

■ Specifications

Parameter	Min	Typ	Max	Units	Notes
General					
Pressure Range	5.8 · 15			PSIG	
Maximum Overpressure			2X		Rated pressure
Operating Temperature Range	-40		85	°C	-40 °F ~+185°F
Storage Temperature Range	-40		125	°C	-40 °F ~+257 °F
Operating humidity	15		85	% RH	No condensation
Media Compatibility	Clean, dry air & noncorrosive gases				
Electrical performance⁽¹⁾					
Excitation voltage	2	5	15	Vdc	
Excitation current					(5)
3.3kOhm (MPS-2303)	0.6	1.5	4.5	mA	
5kOhm (MPS-2307 · MPS-2308)	0.4	1	3		
Bridge resistance					
3.3kOhm (MPS-2303)	2.7	3.3	3.9	kΩ	
5kOhm (MPS-2307 · MPS-2308)	4	5	6		
Offset Voltage	-25		25	mV	
Full Scale Span Voltage					
5.8 PSI (MPS-2307)	50	75	100	mV	
5.8 PSI (MPS-2303)	20	45	70		
15 PSI (MPS-2303 · MPS-2308)	70	100	130		
Linearity	-0.3	0.05	0.3	% Span	(2)
Temperature Coefficient of Zero Offset	-0.08		0.08	% Span/°C	(3)
Temperature Coefficient of Span	-0.16	-0.21 ⁽⁴⁾	-0.26	%Span/°C	Const. voltage excitation (3)
	-0.05	0.025 ⁽⁵⁾	0.05		Const. current excitation (3)
Temperature Coefficient of Resistance	0.17	0.2	0.23	%/°C	(3)
Notes :					
1. Unless otherwise specified, measurements were taken with a supply voltage of 5 Vdc at a temperature of 25±3°C and humidity ranging from 25% ~85% .					
2. Best fit straight line.					
3. Between 0 °C and 50 °C. Temperature coefficients are typical values.					
4. Measured only with constant voltage excitation (5V) .					
5. Measured only with constant current excitation (1mA for 5kOhm sensor ; 1.5mA for 3.3kOhm sensor) .					
Metrodyne Microsystem Corp. reserves the right to make changes to the product specification in this publication.					

■ Terminal connection diagram

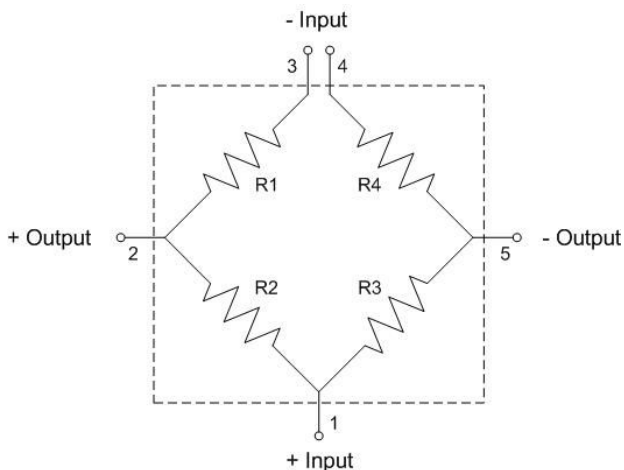

■ **Ordering information**

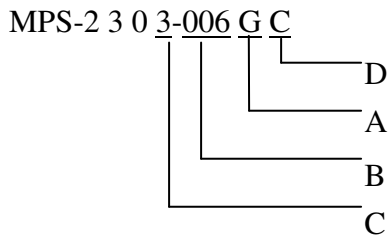

A	Pressure type	B	Pressure range
G	Gauge	006 015	5.8 PSI 15 PSI
C		D	Lead plating
3 7 8	3.3kOhm High sensitivity Low sensitivity	C	Plastic cover

Part No.	Pressure type	Pressure range	Feature	Note
MPS-2303-006GC	Gauge	5.8 PSI	3.3kOhm	Plastic cover
MPS-2307-006GC	Gauge	5.8 PSI	5kOhm	Plastic cover
MPS-2303-015GC	Gauge	15 PSI	3.3kOhm	Plastic cover
MPS-2308-015GC	Gauge	15 PSI	5kOhm	Plastic cover

 **Metrodyne Microsystem Corp.**

10, Prosperity Rd. II, Science-Based Industrial Park, Hsin-Chu 300, Taiwan, R.O.C.

Tel:886-3-5632161 Fax:886-3-5632509

E-mail:sales@metrodyne.com.tw <http://www.metrodyne.com.tw>